



TEMPLE ISRAEL

TEMPLE ISRAEL | 5725 WALNUT LAKE ROAD | WEST BLOOMFIELD, MI, 48323

WEDDINGS





WELCOME TO TEMPLE ISRAEL

Weddings are about stories. The best stories evolve.

That's what you're planning right now, the next evolution of your story. How family histories and backstories, from day you met, to that awkward (or completely smooth!) first date, to coming to the decision to join your families as one.

This day is all about you as a couple, your story will evolve each day going forward, and at the same time there will be a moment frozen in time, when you said, "I do," that will forever stick with you.

It's all about you, and we'd love to be part of that moment. We'd love to be the setting you think back on, when years from now, you think, "remember when...". Whether it's in our outdoor pavilion or inside our sanctuary, we know that we can deliver the setting for the next step of an important story.

Thank you for considering Temple Israel for this moment, and please don't hesitate to ask us how we can help with any planning.

Congratulations,

A handwritten signature in black ink, appearing to read 'J. Plotkin', with a long horizontal stroke extending to the right.

Jason Plotkin, Executive Director



SANCTUARY

Our indoor centerpiece. With welcoming windows that bathe the space in natural light. Includes unique glass entry doors that frost for a dramatic bridal entrance. Large, but intimate at the same time, it can accommodate the largest of weddings.

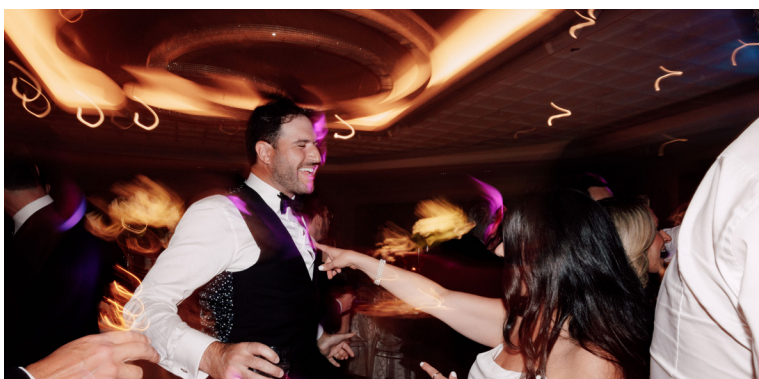

HERMAN HALL

Our elegant ballroom features crystal chandeliers and comes with an advanced-lighting package. The space can be decorated and transformed into your ideal wedding vision.



WASSERMAN ATRIUM

The first impression your guests will have before an indoor service. Our atrium is filled with natural light from stunning skylights, and sophisticated lighting for evening events. An ideal location for cocktails.



SCHMIER CHAPEL

A more intimate space that can accommodate up to 150 guests.



KORMAN HALL AND ATRIUM

Our smaller reception hall and adjacent atrium. An ideal fit for a more intimate and smaller ceremony, or reception.

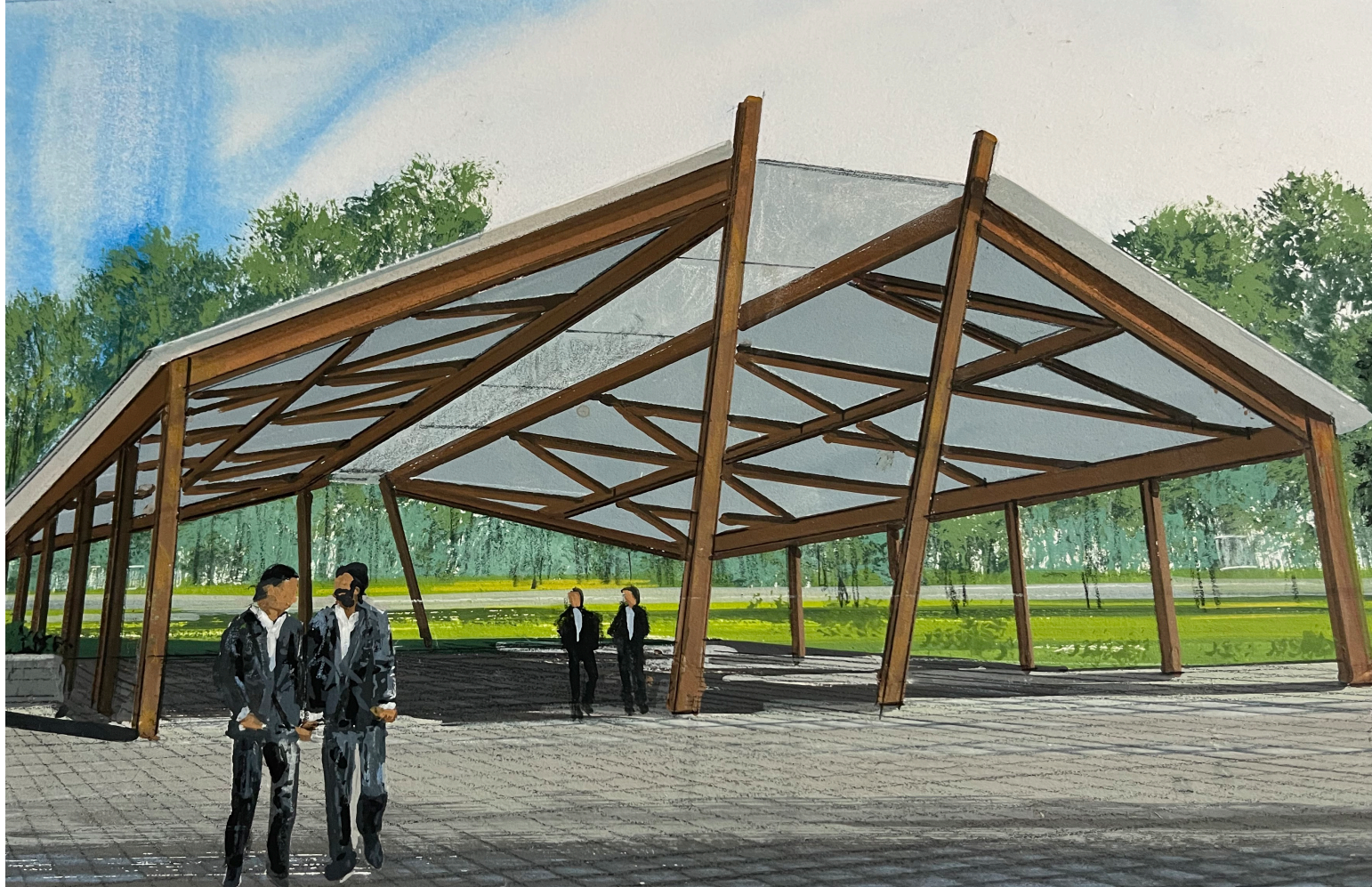

OUTDOOR PAVILLION RENDER

Temple Israel is always growing and improving. Expected to be built in 2024, our new outdoor pavilion will be the perfect spot for your celebration.



UPPER PATIO

Directly connected to the outdoor Sanctuary Pavilion and within close proximity to the inside Sanctuary, our Upper Patio is a fresh, refreshing space that fits perfectly for cocktail hours and standing receptions.



OUR SPACES

Indoor Service Rental Costs: \$2,550/members | \$3,550/non-members

*Non-membership subject to Rabbi and Clergy fees

Outdoor Service Rental Cost: \$3,550/members | \$4,550/non-members

*Outdoor rental comes with a guaranteed backup space should weather interfere

ALL RENTAL PACKAGES INCLUDE

- Designated Ceremony & Celebration Spaces
- Private area for Ketubah Signing
- Accompanist for Ceremony
- Ceremony sound system
- Chuppah for use inside Chapel or Sanctuary
- Bridal Attendant for both rehearsal and ceremony
- Tables in various sizes
- Mahogany folding chairs
- Black Dance Floor
- Set-Up & break down of Temple Israel equipment
- China, flatware, glassware
- Building security

FOOD AND BEVERAGE

As part of your Temple Israel booking we provide all the plateware, glassware, and flatware. Our place setting includes chinaware, silverware, and glassware. In addition to providing tables and chairs, this is an expense that Temple Israel covers where most venues require an additional rental.

Temple Israel is proud to work with three partnered catering companies who will work to find the ideal menu for your perfect day.

CELEBRITY CATERING

Lize Trombley
248.817.6880 | eventmanager@celebritycateringusa.com
www.celebritycateringusa.com



FORTE BELANGER

Kate Berris
248.602.4506 | KBerris@fortebelanger.com
fortebelanger.com



PLATINUM DISH CATERING

Paul Wertz
947.207.9957 | pjwertz@socialeventsonline.com
www.platinumdish.com



FOOD AND BEVERAGE

KOSHER MENU

A Kosher Menu can be provided by request.

ALCOHOL POLICY

Temple Israel knows that it's your day, so you should be able to pick the drink menu. The couple can purchase their own outside alcoholic beverages or use the catering company to place the order.

IDEAL ADD-ONS

Premium White Dance Floor (Indoors only) | \$500

Stage or Riser (Per Piece of 4x6 or 4x8) | \$100

Pitt Atrium (For Additional Usage) | \$250

Powder Room and Coat Attendants | \$250

Additional Security | \$250/per security staff

Overtime fee (events ending after midnight) | \$500/per half hour

FAQS/POLICIES/PROCEDURES

SPACE CAPACITIES

*Depending on set-up needs

Herman Hall: 100' x 72' (Roughly 280-350 guests)

Wasserman Atrium: 64' x 65' (Roughly 150 guests)

Korman Hall: 59' x 59' (Roughly 150 guests)

Korman Atrium: 25' x 59' (100 guests)

Pitt Atrium: 37" x 36' (70-75 guests)

DANCE FLOORS

Herman Hall: 21' x 21', 24' x 24', 24'x27' adjustable in 3' increments; up to 30' x 30'

Korman Hall: 18' x 18', 24' x 24', 21'x27' adjustable in 3' increments; up to 21' x 21'

CANCELLATIONS OR TRANSFERS

All cancellations or requests to change the date of an Event must be submitted in writing. In the event of a cancellation within 24 months prior to your event, your deposits will be forfeited. Date change requests shall be considered based on availability, within same fiscal year.

EVENT SET-UP & BREAK DOWN

Events set-up may begin—

Saturday: 8:00 am with quiet hour between 10:00am -12:00pm out of respect for religious services taking place. Atrium set up cannot begin until 1:00pm.

Sunday: 1:00pm based on if religious services are taking place.

Temple Israel staff is not able to assist with arranging of place cards, favors, tasting flutes, cake knives, server menus, guestbooks, or pen-card boxes. These items must be placed within 24 hours prior to the event and labeled.

Following the conclusion of the wedding reception, renter will ensure all items shall be removed from the premises within the hour. All décor, not belonging to Temple Israel, including but not limited to flowers, must be removed at the end of the event or there will be a minimum \$250 clean-up and disposal fee. Temple Israel shall not hold any items after the conclusion of the Event without prior consent. Temple Israel is not responsible for any items left behind.

TABLES & CHAIRS

Temple Israel provides all guest, cocktail, place card, challah, gift, and cake tables. Sizes are limited. We also provide mahogany folding chairs as part of our package.

FLOOR PLANS, TABLESCAPE, LINENS

An approved and final floor plan will be due fourteen (14) business days prior to the event.

Temple Israel will not place or remove any rental linens or napkins on any tables. Temple Israel is not responsible for missing or damaged linens or napkins.

EVENT ITINERARY

A tentative timeline is due fourteen (14) business days before the event

PHOTO POLICY

Member agrees to allow Temple Israel to take photos of their event for the purposes of marketing and social media.

VENDORS

Vendors must be approved by Temple Israel. Temple Israel is not responsible for the installation or removal of items provided by an outside vendor. Violation of this policy may result in additional charges against your security deposit.

SANCTUARY SCREEN GUIDELINES

Suggested guidelines for selecting wedding photos for the sanctuary screens
You may adorn our sanctuary with your own romantic photos on our sanctuary screens during your wedding

1. Photos–

If you would like to use a photo of your own or your already created wedding logo, it must be following the formatting listed below. Think of this photo as the artwork adorning the sanctuary during your sacred ceremony. Thus, the photo should be romantic and beautiful. Although we often employ humor in our weddings, this is not the best spot for comic photos or anything that would draw attention away from the wedding couple. Since we are in a sanctuary, many would prefer not to feature photos that focus on the human face, so portraits may not be the best choice for this application. That said, romantic photos of the couple holding hands in the distance or getting engaged often work beautifully as do pictures of the couple's favorite romantic landscape.

Screen Resolution:

1280x720(HD)

1920x1080 (FHD)

2560x1440

3840x2160 (4K)

7860 x 4320 (8K)

2. Or choose from any of the following photos which we provide at no charge



A) Chuppah



B) Chuppah Sunset



C) Siddur Ring



D) Ketubah Rings



E) Rose Pattern



F) Lace Pattern



G) Bouquet Pattern



H) Personal Graphic

ADDITIONAL POLICIES

- Temple Israel is a smoke-free facility and smoking is not allowed in the facility or surrounding premises.
- No Pork Products of any kind are allowed.
- Throwing and/or using confetti, rice, birdseed, glitter, etc. is not permitted in the facility or surrounding premises.
- All candles must be encased in glass.
- Taping of items from the walls or ceiling is not permitted.
- Hanging of photos or signs to be hung by Temple approved vendors within the ceiling track only or client provided pipe & drape.
- All power cords must be taped / secured to floor with vendor provided Gaffer Tape.
- Wedding cakes must be prepared by a licensed bakery.
- Day-of Coordinators not provided but can be recommended.



SIMCHA TASTE SPACE



TEMPLE ISRAEL | 5725 WALNUT LAKE ROAD | WEST BLOOMFIELD, MI, 48323